

Surveyed by Homer Hicks, Surveyor Clay County Ind April 16 1873, Chain carriers sworn.

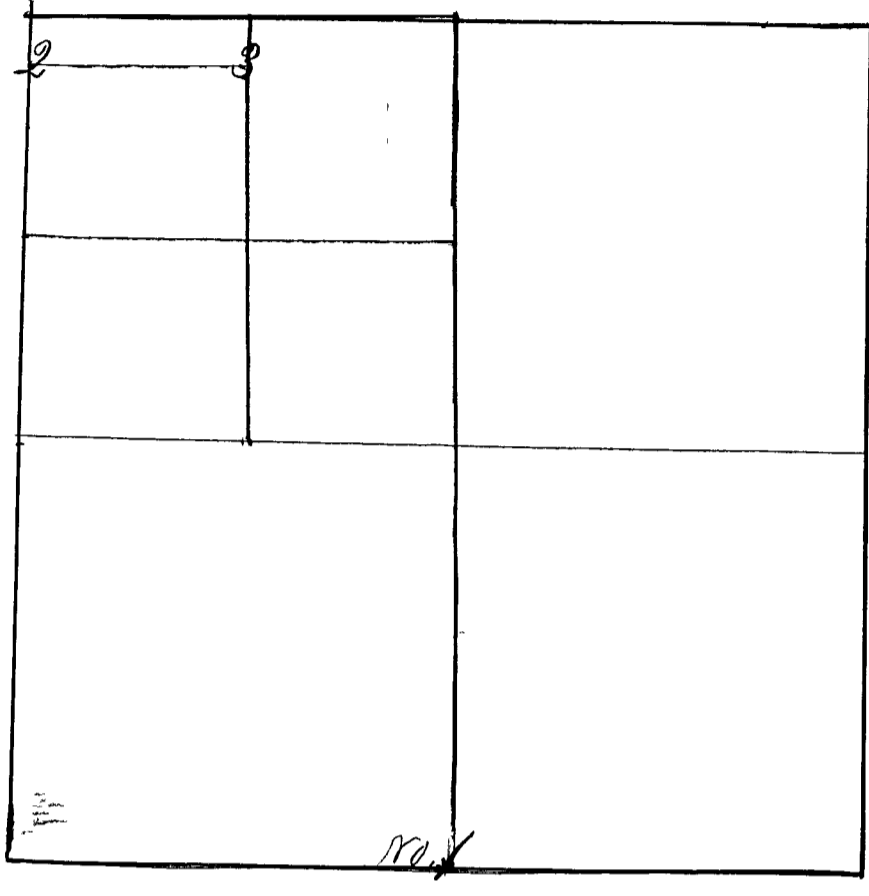

Corner No. 1 Sand Stone marked $\frac{1}{4}$ S
 Met. { A Brick building N. 52° W. S. E. corner distant 37 $\frac{1}{2}$ lks.
 A Locust 6. S 36 $\frac{1}{2}$ W. 37 $\frac{1}{2}$ lks.
 Homer Hicks. S. C. C.

Further surveyed August 24th, 1881. by Homer Hicks Depty. S. C. C.
 Survey made at the request of Henry Shultz - James Mustard
 and Henry Huckridie chainmen - Sworn.

Corner No. 1. a sand stone 18 ins. long south of N. W. Cor. of sec. 39 1 chm.
 " N. 2. " " " " 12 " " " " the middle
 " " " " " of the N. line of the N. W. gr. 3.91 chm.
 Homer Hicks Depty S. C. C.